

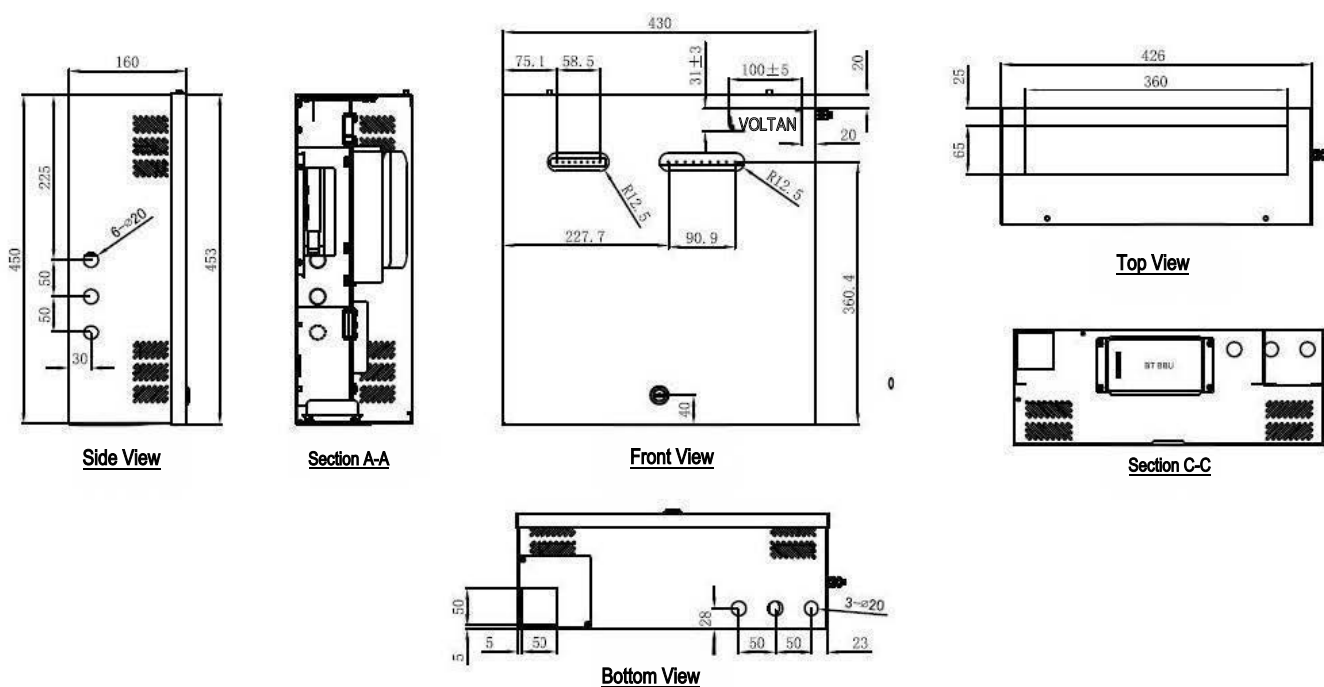

PRODUCT OVERVIEW

Voltan Consolidation Network Cabinet is an ideal solution for managing networking and electronic equipment in a residential or small office setup. Designed to be compact and efficient, this wall-mounted cabinet offers organized space for routers, switches, and other network components.

CONSTRUCTION DRAWING



PRODUCT SPECIFICATIONS

Feature	Values
Mounting Profile	Yes
Model	Residential
Type of profile rail	L - Shaped
Number of doors	1
Width	430 mm
Height	453 mm
Depth	160 mm
Modular Spacing	254 mm (10 inch)
With roof plate	Yes
With front door	Yes
Side panels included	No
Material	Steel
Type of surface	Powder coated
Colour	Grey White
RAL-number	9002

ADDITIONAL SPECIFICATIONS

Features	Values
Cable entry / exit	Brush strip
Bottom cable entry holes	3 x 20mm
Bottom entry square hole	50mm x 50mm
Left/right side cable entry	3 x 20mm
IP rating	IP20
Material thickness	1.2mm
Material coating	Powder Coating
M6 Earthing stud	1
Operating temperature	-40 to +60 °C
Intergrated Tie points	Top / Bottom

INCLUDED ACCESSORIES

Accessories	Information	Quantity
Nylon Cable Tie	200mm x 4mm	10
Velcro Tie	285mm x 20mm	4
Twist Tie		4
Removable / Lockable door		1
Port Identification Label		1

STANDARDS

Applicable Standard	Detail
RoHS-II/-III (2011/65/EU & 2015/863): 2023	Our products, demonstrate full adherence to the regulatory stipulations of the EU Directive 2011/65/EU (RoHS-II) and its corresponding delegated directive 2015/863 (RoHS-III).

ORDERING INFORMATION

Part Number	Description
VWNC454316	Voltan Wall Mount Metal Network Cabinet Box - 453 x 430 x 160 mm